

TOTAL EXTENT (AS PER DOCUMENT) : 2698 Sq.M
ROAD AREA : 537 Sq.M
PUBLIC PURPOSE AREA (1%) : 29 Sq.M
 PP-1 HANDED OVER TO THE LOCAL BODY (0.5%) = 15.0 Sq.m
 PP-2 HANDED OVER TO THE TANGEDCO (0.5%) = 14.0 Sq.m
NO. OF PLOTS : 21 Nos.

NOTE:

1. SPLAY - 1.5M x 1.5M
 2. MEASUREMENTS ARE INDICATED EXCLUDING SPLAY DIMENSIONS
 3.

	ROAD AREA
	PUBLIC PURPOSE-1
	PUBLIC PURPOSE-2
- (RESERVED FOR TANGEDCO) WERE HANDED OVER TO THE LOCAL BODY VIDE GIFT DEED DOC.NO:2954/2021, DATED:30.06.2021 @ SRO, POONAMALLEE.

CONDITIONS:

(I) TNCDBR-2019 RULE NO: 47 (8) IN G.O.(Ms) No.18, MAWS DEPARTMENT DATED 04.02.2019 & AMENDMENTS APPROVED IN G.O.Ms.No.16, MAWS (MAI) DEPARTMENT DATED 31.01.2020 AND PUBLISHED IN TNGG ISSUE No.41.DATED 31.01.2020

ONE PERCENT OF LAYOUT AREA EXCLUDING ROAD, ADDITIONALLY, SHALL BE RESERVED FOR "PUBLIC PURPOSE". WITHIN THE ABOVE CEILING 0.5% OF AREA SHALL BE TRANSFERRED TO THE LOCAL BODY AND 0.5% OF AREA SHALL BE TRANSFERRED TO THE TANGEDCO OR TO THE LOCAL BODY FREE OF COST THROUGH A REGISTERED GIFT DEED BEFORE THE ACTUAL SANCTION OF THE LAYOUT.

(II) TNCDBR-2019, RULE NO: 47 (11)

THE COST OF LAYING IMPROVEMENTS TO THE SYSTEMS IN RESPECT OF ROAD, WATER SUPPLY, SEWERAGE, DRAINAGE OR ELECTRIC POWER SUPPLY THAT MAY BE REQUIRED AS ASSESSED BY THE CONCERNED AUTHORITY, NAMELY, THE LOCAL BODY AND TAMIL NADU ELECTRICITY BOARD, SHALL BE BORNE BY THE APPLICANT.

● NECESSARY SPACE FOR BUILDING LINE TO BE LEFT AS PER THE RULE IN FORCE WHILE TAKING UP DEVELOPMENT IN EVERY PLOT.

LEGEND:

- SITE BOUNDARY
- ROAD GIFTED TO LOCAL BODY
- EXISTING ROAD
- PUBLIC PURPOSE-1 GIFTED TO LOCAL BODY
- PUBLIC PURPOSE-2 GIFTED TO TANGEDCO

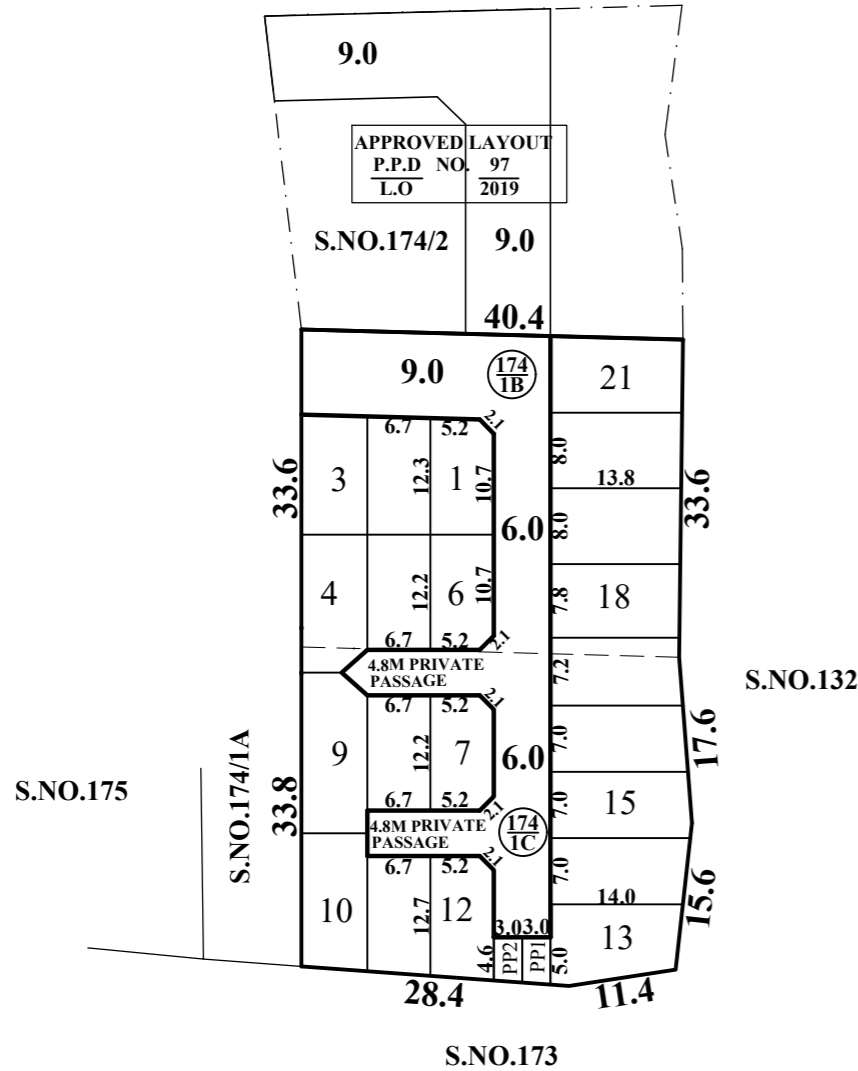

This Planning Permission Issued under New Rule TNCDBR.2019 is subject to final outcome of the W.P(MD) No.8948 of 2019 and WMP (MD) Nos. 6912 & 6913 of 2019.

CONDITIONS:

THE LAYOUT APPROVED IS VALID SUBJECT TO OBTAINING SANCTION FROM THE LOCAL BODY CONCERNED.

P.P.D NO : 99
L.O 2021

APPROVED

VIDE LETTER NO : L1 / 14467 / 2020

DATE : 08 / 07 / 2021

OFFICE COPY

FOR CHIEF PLANNER (LAYOUT)
 CHENNAI METROPOLITAN
 DEVELOPMENT AUTHORITY



THIRUMAZHISAI TOWN PANCHAYAT

LAYOUT OF HOUSE SITES IN S.No. 174/1B & 1C OF THIRUMAZHISAI VILLAGE.

SCALE : 1:800 (ALL MEASUREMENTS ARE IN METRE)